

PROPER CFC KIT INSTALLATION BULLETIN

This Bulletin Is Being Released to Stress The Importance of Proper Installation of the CFC Kit.

On the Reverse is the Complete K-Style Ultra CFC Kit Installation Instructions. Below are

The installation of the **COVER PLATE** is critical to prevent the top seal from leaking under operational conditions. The properly installed cover plate will prevent the collar of the suspension bag from "rolling" off the shelf of the dampener opening.

The following steps will help to insure proper seal of the cover plate.

- ① Make sure the throat of the dampener, including the sealing "shelf" is clean and dry prior to the installation of the suspension bag.
- ② Make sure the OD of the collar on the suspension bag is clean and dry prior to the installation into the pulsation dampener.
- ③ Make sure the collar of the suspension bag is **FIRMLY** placed on the "shelf" in the throat of the dampener.
- ④ After the compression wedges are properly installed, double check that the suspension's bag's collar is **STILL** firmly placed on the "shelf" in the throat of the dampener.
- ⑤ On the bottom of the cover plate, liberally lubricate the OD of the plug with mineral oil.
- ⑥ On the ID of the collar of the suspension bag, liberally lubricate with mineral oil.
- ⑦ When installing the cover plate, insure the plug on the cover plate is inserting into the suspension bag from a **STRAIGHT VERTICAL** position. This will keep from pulling the collar off the "shelf" in the throat.

IF YOU ARE EXPERIENCING ANY CHALLENGES PLEASE USE THE FOLLOWING QUICK CHECK LIST:

If you discover your CFC Kit was improperly installed, follow the steps below to insure proper installation:

- ⦿ Make sure the cover plate has been properly torqued down.
- ⦿ Sometimes simply increasing the torque on the cover plate nuts is enough to energize the seal.
- ⦿ If torquing the cover doesn't solve the issue, pull the cover plate off for reinstallation.
- ⦿ Pull the CFC Kit completely out of the dampener, then thoroughly clean the CFC Kit Bag and the dampener sealing surfaces and throat with water.
- ⦿ Follow the steps on reverse for proper installation.

We recommend that when you have a service company install the CFC Kit, you request the following information:

- Torque device name and model number
- Max torque the device is capable of
- Lube to be used on bolts and nuts
- Have the person doing the install document the torque reached on each nut and stud

Improper torque is the number one cause of premature failure with the Kits.



If you have any questions, please call:
Josh Huff (832) 470-3220

K-STYLE ULTRA CFC KIT INSTALLATION INSTRUCTIONS

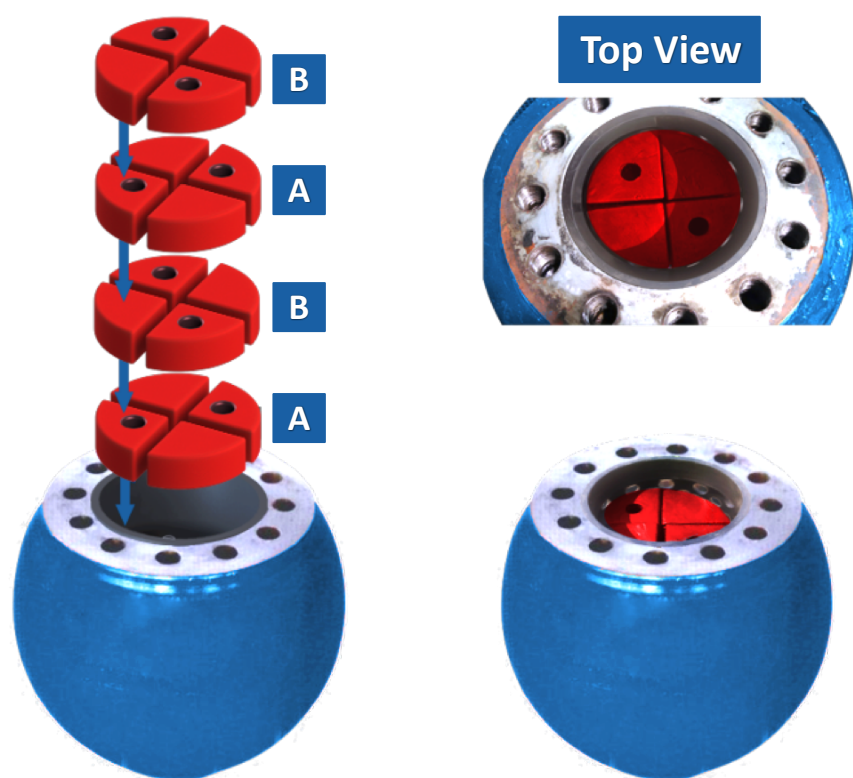
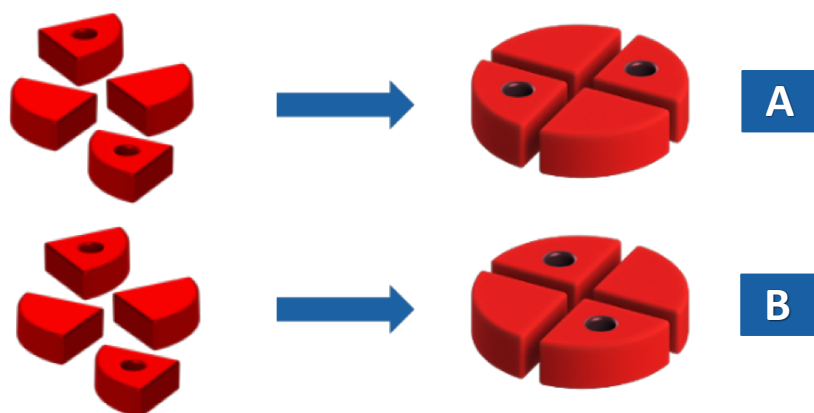
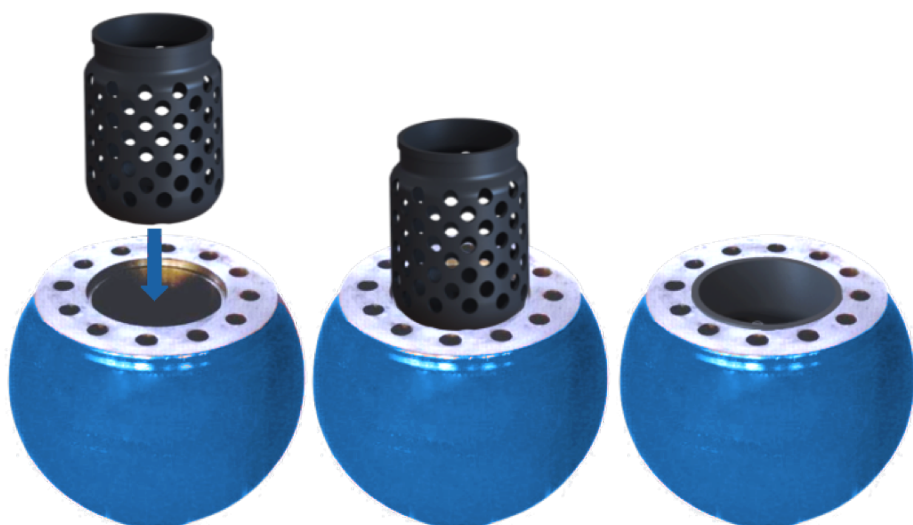

- ① Insure the dampener isn't retaining pressure
- ② Remove the cover plate
- ③ Remove the existing gas bladder
- ④ Install the Sigma Suspension Bag into the dampener
- ⑤ Place four Sigma Compression Wedges in the Suspension Bag in pattern **A**
- ⑥ Place four more Sigma Compression Wedges on top of the first layer in pattern **B**
- ⑦ Repeat pattern **A**
- ⑧ Repeat pattern **B**
- ⑨ Lubricate the inside edge of the Suspension Bag collar
- ⑩ Carefully reinstall the dampener cover plate so you don't slip the Suspension Bag collar off the sealing surface
- ⑪ Use threadlocker and torque the nuts down to appropriate lb-ft